

FINAL PLAT
TEAS LAKES
 SECTION THREE
 A SUBDIVISION OF 19.901 ACRES
 OF LAND IN THE
 MARTIN P. CLARK SUR., A - 148
 MONTGOMERY COUNTY, TEXAS
 SINGLE FAMILY RESIDENTIAL
 CONTAINING 98 LOTS, 2 BLOCKS
 AND 2 RESTRICTED RESERVES

OCTOBER 2004
 OWNER/DEVELOPER
 Chibran Co. L.L.C.
 206-A S. Loop 336 W Suite # 211
 Conroe, Texas 77304
 (936) 890-3678
 Fax (936) 890-3618

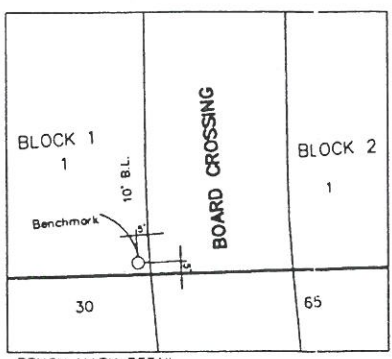
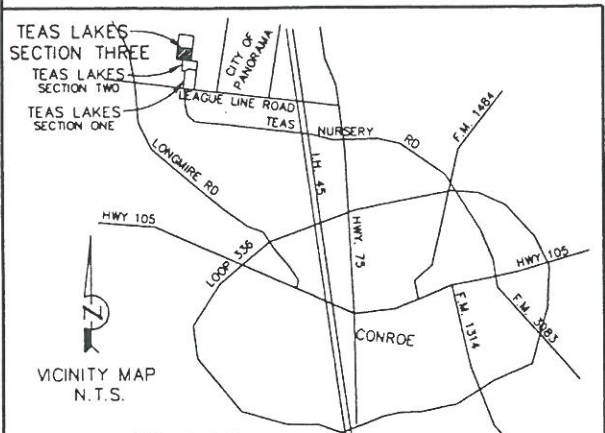

BENCH MARK DETAIL
 The site benchmark consists of a three inch disk set in a concrete column, and stamped TL3 Elevation = 300.00

Job # 2004-119234 Cal. W Sheet 189

JEFFREY MOON
 AND ASSOCIATES INC.
 LAND SURVEYORS
 P. O. Box 2901
 Conroe, Tx 77305
 (936) 754-5266
 FAX (936) 756-5281